

L.E. BACA

CONSTRUCTION

Architecture - Engineering - Construction
Since 1984

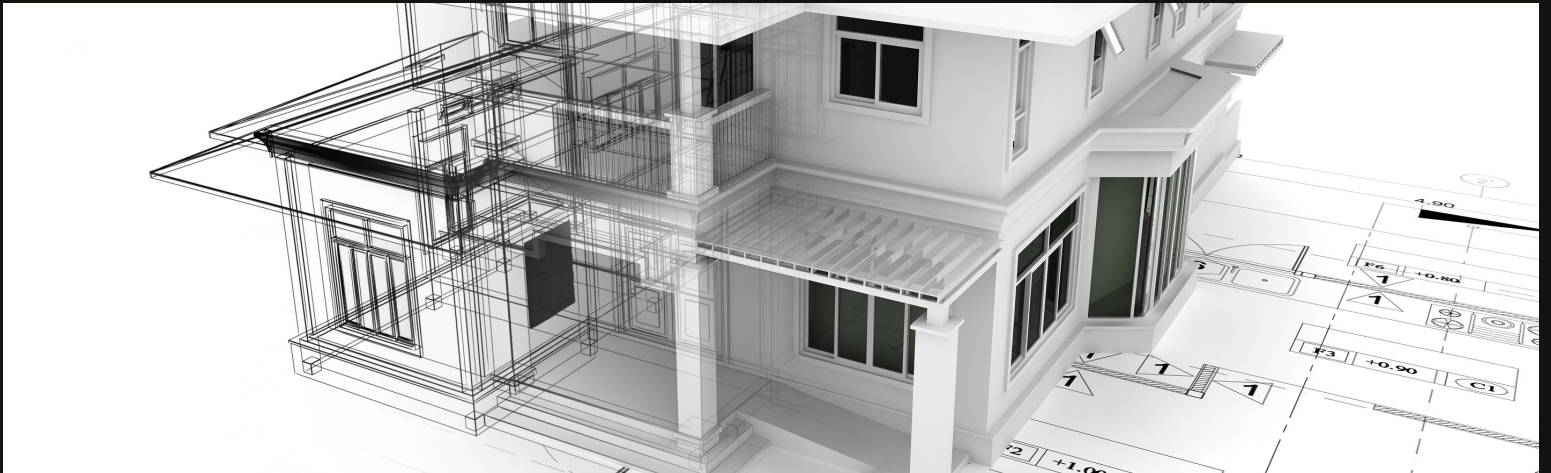

DESIGN BUILD
EXPLAINED

DESIGN BUILD
PROCESS

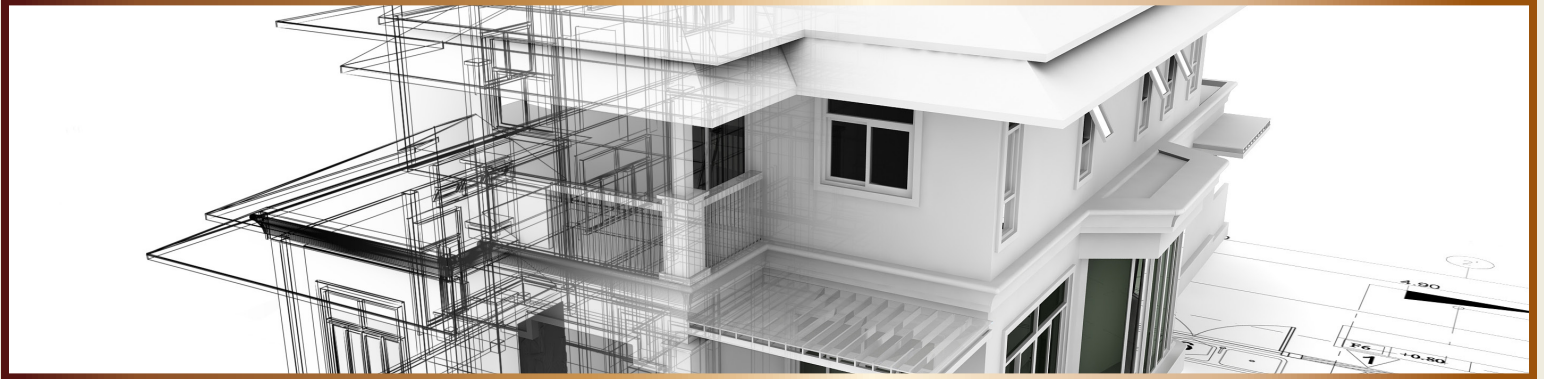

ESTABLISHED 1984

Lic: 450941

COMING SOON

W H O — W E — A R E



A Venn diagram consisting of two overlapping circles. The top circle is on the left and the bottom circle is on the right. The text 'DESIGN BUILD' is positioned above the circles, and 'PROCESS' is positioned below them. The letters 'I', 'G', 'N', 'B', 'U', and 'I' are positioned within the top circle, while 'P', 'R', 'O', 'C', 'E', and 'S' are positioned within the bottom circle. The intersection of the two circles contains the letters 'I', 'G', 'N', 'B', 'U', and 'I' from the top row and 'P', 'R', 'O', 'C', 'E', and 'S' from the bottom row.

DESIGN BUILD
PROCESS

L.E. BACA
CONSTRUCTION

Architecture - Engineering - Construction
Since 1984

www.bacaconstruction.com